

CAN ART

ALUMINUM EXTRUSION INC.

CUSTOMER

CAN ART STD.

DESCRIPTION

5.000 X 2.000 X 0.125 RECT. TUBE.

CUSTOMER PART No.

DIE No. **EH04027**

REV No. **1**

QUOTE No.

14-0896-1

PROPOSAL No.

H-30582

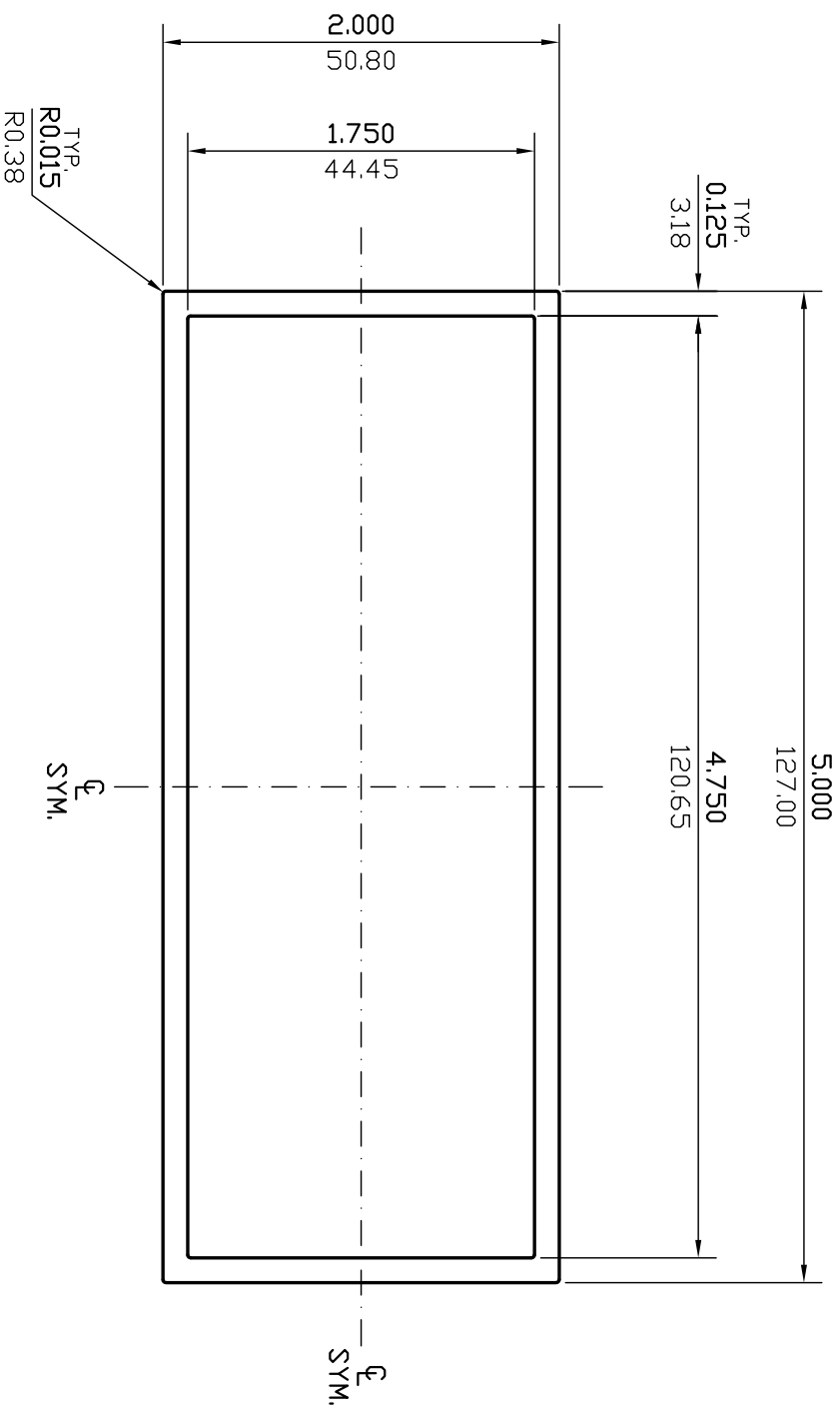

WALL THICKNESS **0.125(3.18)** EXCEPT AS SHOWN

DATE	REV	DESCRIPTION	BY	EST. AREA	1.687	IN ²	EST. AREA	1088.716	MM ²
03/14/23	1	REMOVED ALL DY	JASDN	EST. WT.	1.991	LBS./FT.	EST. WT.	2.963	KG./M.
				EST. PER.	26.948	IN.	EST. PER.	684.492	MM.
				OUT PER.	13.974	IN.	OUT PER.	354.9	MM.
				C.C.D.	5.374	IN.	C.C.D.	136.493	MM.
				FINISH	M/F		ALLOY		
				OKD BY	FACTOR 14	SCALE 1:1	DWN BY D.L.	DATE 08/26/2014	

85 PARKSHORE DRIVE
BRAMPTON, ONT L6T 5M1

TEL. NO. (905) 791-1464
FAX NO. (905) 791-9151
WEB: www.canart.com

THIS DRAWING IS NOT NECESSARILY A COPY OF YOUR ORIGINAL. PLEASE APPROVE DIMENSIONS AND TOLERANCES INDICATED. CAN ART ASSUMES NO RESPONSIBILITY EITHER TECHNICAL OR LEGAL FOR HAVING THIS SHAPE MADE. THE CUSTOMER AGREES TO FULLY PROTECT CAN ART ALUMINUM FROM CLAIMS OF OTHERS RESULTING FROM THIS SHAPE.

SIGNED: _____ DATE: _____

NOTE: BREAK ALL CORNERS WITH 0.015" (.38 MM) RADIUS UNLESS OTHERWISE NOTED. STANDARD TOLERANCES TO APPLY UNLESS OTHERWISE SPECIFIED.